

WE SELL NOT ONLY GUNS, BUT ALSO DREAMS



LCTairsoft LCTairsoft lctairsoft_official lctairsoft Kevin Lctairsoft

www.LCTairsoft.com

LI CHENG Technique Bussiness Co.

✉ No. 89, Ln. 535, Ganzhu Rd., Hemei Township, Changhua County 508, Taiwan(R.O.C)

☎ +886 4 7355551 📠 +886 4 7364887

✉ service@lctairsoft.com

LK33-V202007

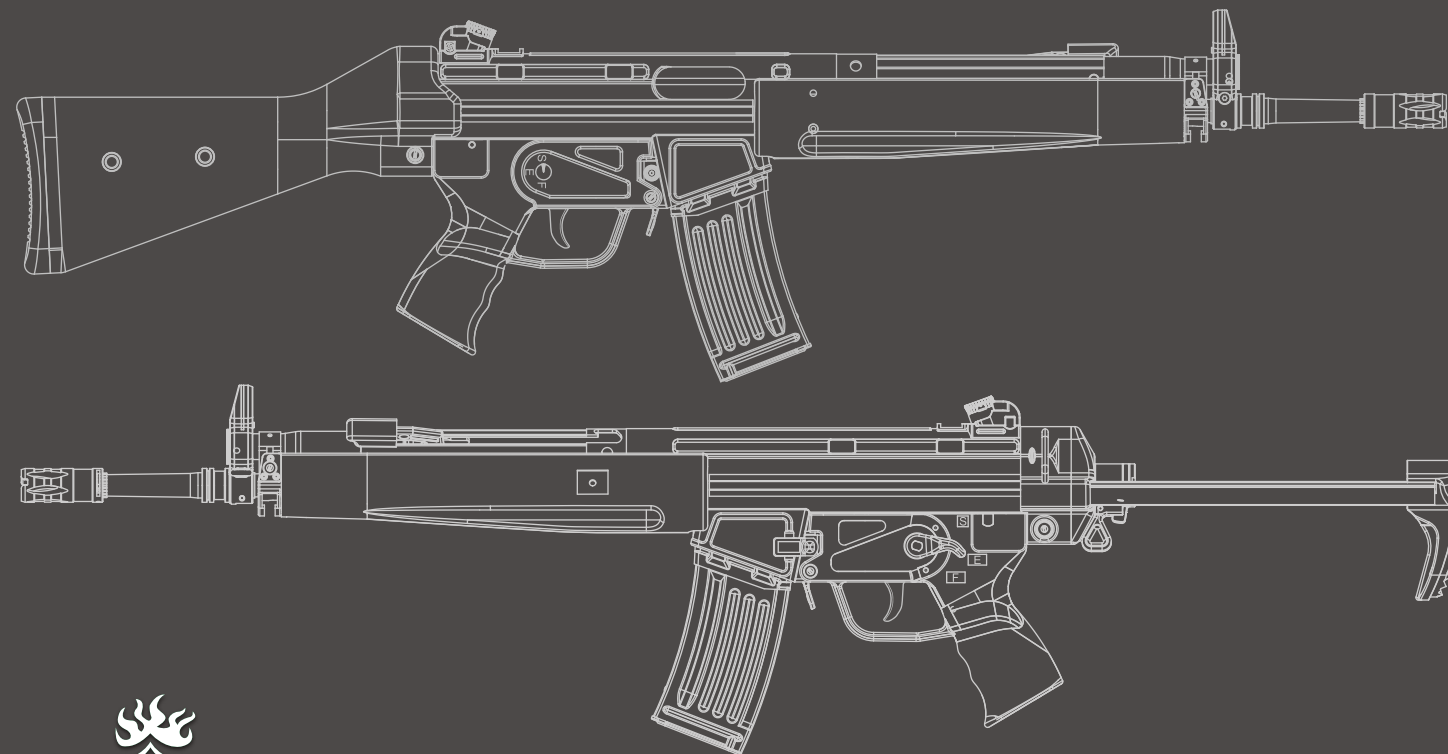

LK33 SERIES **AEG** **EBB** **CH** **EN**

GENERAL OPERATION MANUAL



ELECTRIC
BLOWBACK



LK-33A2



LR-223

LK-33A3



LK-33AR



WARNING Safety instruction



勿將槍口朝向人或動物
Never let the muzzle toward people or animals as target.

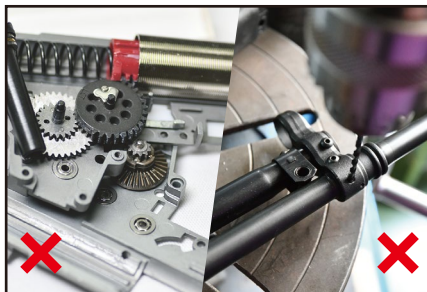

請勿任意拆解內部零件，或惡意改裝
Do not disassemble internal parts at will, or modify maliciously.



請妥善保管，切勿供未成年人任意取用操作
Please keep it in a safe place, and do not allow it to be used by any children under legal age.



敬請使用原廠規格6mm塑料BB彈。嚴禁使用金屬或其他非原廠規格BB彈，以免觸法。
Please use LCT specification 6mm plastic BB bullet.
To avoid breaking the law, the use of metal or other non-original specifications BB bullets is strictly prohibited.

PLAY SAFELY & SMARTLY



射擊時請全程配戴護目鏡/安全配備，並隨時留意周邊安全
Be sure to wear safety glasses / goggles when shooting, or other protective gears in necessary. Always pay attention to the security around you.

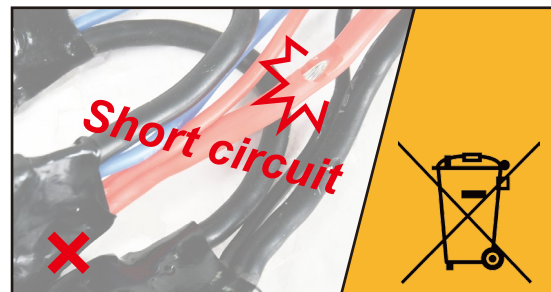

勿使用破損或不當尺寸電池，將導致短路故障。使用完畢請移除電池，嚴禁任意丟棄廢電池
Do not use damaged or improperly sized batteries, which will cause a short circuit breakdown. Please remove the battery after being used.
It is strictly forbidden to discard waste batteries improperly.



OPERATION Battery Installation

LK-33A2



往下推開槍托底板
Push downward to remove the butt plate.

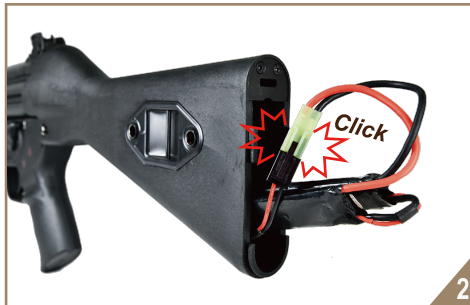

連接電池，注意接頭方向，將電池收納於槍托內
Pay attention to the direction of the socket when connecting the battery.



反向裝回槍托底板
Replacing the butt plate by opposite direction.

LK-33A3



移除護木固定插銷
Remove the locking-pin in front of the handguard.



連接電池，請勿強行安裝非建議尺寸電池
Connect the battery, Do not force to install non-recommended size batteries



裝回護木時請留意電線位置，插回插銷
Pay attention to the position of wires when replacing the handguard to avoid damage. Insert locking pin again.

LCTairssoft

5

敬請使用LCT高精度/生物分解BB彈 Please use LCT high precision/ BIO BBs.

Mid-Cap.



無聲彈匣使用填彈器(另購)裝填
Using a BB loader(excluded) to fill in the mid-cap magazine.

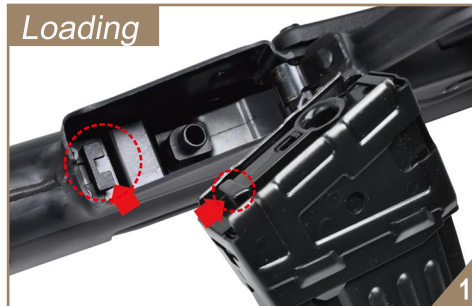

以傾斜方式將彈匣前方插入彈匣勾(紅色箭頭位置)
Tilt and insert the hook into the magazine socket. (show as red arrows)

Hi-Cap.



開啟彈匣上方填彈口填入BB彈，填滿後請確實關妥蓋子
Open the magazine top lid and fill in BBs. Make sure the cover firmly closed.



再將彈匣後方推入彈匣井(箭頭方向)，直到卸彈鈕固定住彈匣
Insert it into magazine magwell (as red arrow) until until the magazine set firmly.

Loading Magazine OPERATION



上緊底部上彈發條(單向)，直到發出喀喀聲
Wind the spring ratchet (One way) at the bottom of magazine until hearing crackling sound.



握穩彈匣，以拇指前推(A)/按壓(B)卸彈鈕即可卸下
Hold the magazine, push the magazine release lever(A) or press the button(B) for unloading.

6

OPERATION Safety / Fire selector



保險 S=SAFE



單發 E=Single fire



連發 F=Burst

三段火控選擇鈕位於槍身左側。非射擊時，請隨時將火控置於保險位置。

The three position selector lever is situated on the left side of the grip assembly. Beside shooting, please keep selector on safe position in any time.

OPERATION Retractable Stock

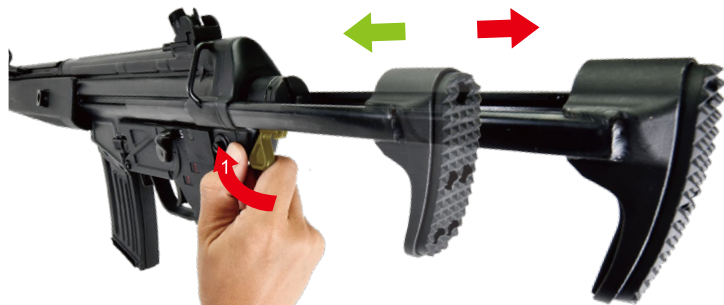

依箭頭(1)方向轉動後托開關鈕，可展開或縮回槍托
Pulling the Stock adjustment lever, make the stock fully expanded or collapsed.



槍托鎖定於最短位置時，不可有空隙
It should be without any gap while the stock been fully collapsed.

Windage Adjustment



鬆開照門座固定螺絲 Loosen clamping screw on top of sight base.

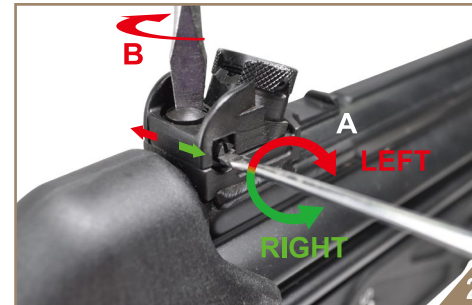

(1)左右調整風偏修正螺絲，調整完畢鎖緊
覘孔座固定螺絲(2)

Turn adjusting screw(A) on the right side according to requirement. The clamping screw(B) should be tightened after adjustment.

Apertures Selection



手動旋轉照門，依彈著選擇覘孔高低位置(順時針降低，逆時針調高)
Rotate sight cylinder in desired direction by hand; (to lower point of impact turn clockwise, to raise point of impact turn counter-clockwise.)

Sight pictures

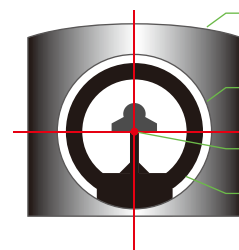

Correct Point of Aim
正確瞄準圖

Rear sight 後照門
Aperture 覘孔
Point of impact 彈著
Front sight 前準星



Incorrect Point
LEFT 偏左



Incorrect Point
RIGHT 偏右



Incorrect Point
HIGH 偏上

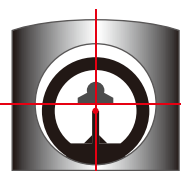

Incorrect Point
LOW 偏下



向後拉動槍機拉柄，固定於缺口中
Pull back the cocking lever and stabilize it at the notch.



調整HOP UP時嚴禁觸動拉柄
Do not touch the cocking lever while adjusting HOP UP.

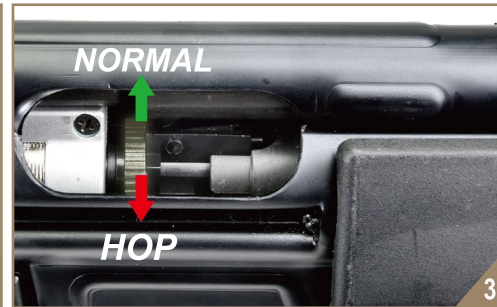

調整HOP UP，使彈道保持最佳位置(如下圖)
Dial HOP UP to HOP or NORMAL direction. Keep the best trajectory. (Fig. 1)

CAUTION



調整HOP UP時慎防夾傷手指
Be careful not to pinch your fingers while adjusting HOP UP.

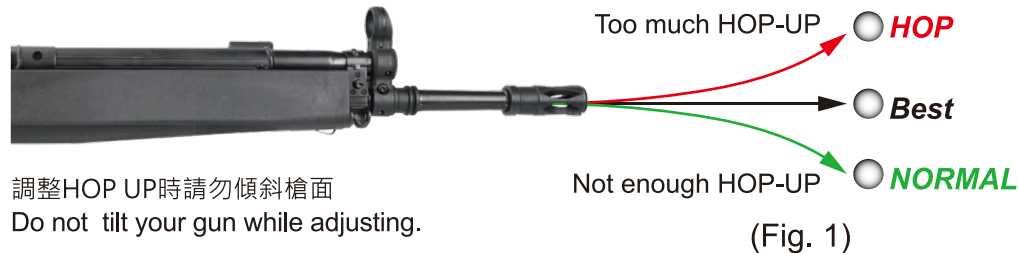

調整HOP UP時請勿傾斜槍面
Do not tilt your gun while adjusting.

(Fig. 1)



卸除後托插銷及槍托總成
Remove the locking pin and detach the stock assembly.



使用一字起子卸除尾頂桿(如圖示操作)
Remove the spring guide by a flathead screwdriver. (Operate as graphic)

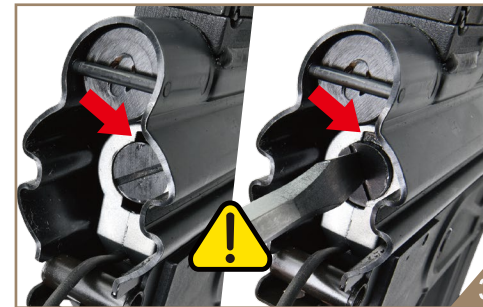

尾頂桿凸耳對齊齒輪箱缺口，注意零件彈出
Align lugs of spring guide and the slot of gearbox. Be careful of parts to pop up.



抽出尾頂桿及彈簧
Take out the spring guide and spring.

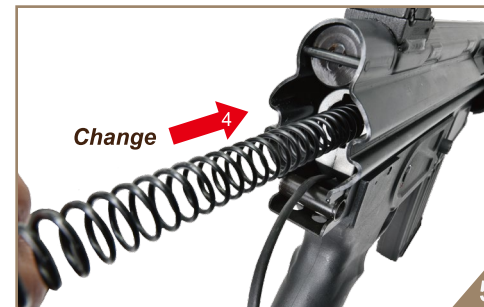

更換彈簧，以相反步驟裝回尾頂桿及槍托
Change the spring, reinstall the spring guide and stock by reverse steps.



QM Spring series 快拆彈簧系列

PK401 QM135 (m/s) PK400 QM120 (m/s)

PK399 QM110 (m/s) PK398 QM100 (m/s)

PK397 QM 90 (m/s)

警告 WARNING
Do not violate local velocity regulations.

Bipod
LK010



對齊護木腳架結合座卡槽，滑入即可固定
Align the bipod mounting gap in front of handguard. Slide and catch a bipod.



往下按壓腳架按鈕，可收起/展開腳架
Press the button downward to fold / unfold a bipod.



按壓護木下方彈片，即可移除腳架
Press the leaf spring attached to the bottom of handguard to detach a bipod.

Bayonet adp.
LC006

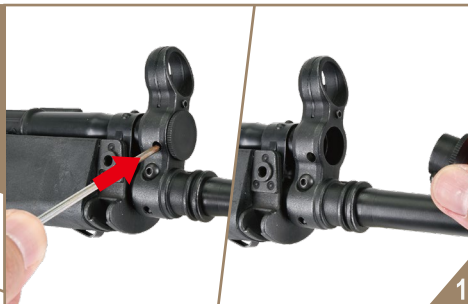

移除飾蓋
Remove the cover.

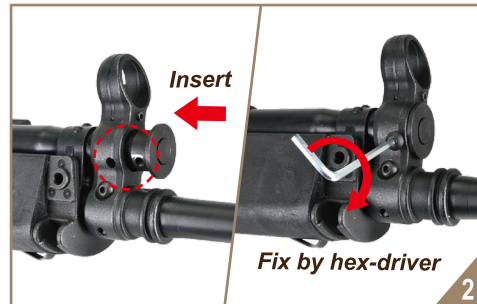

安裝刺刀座
Insert and fix the bayonet adapter.



安裝範例(不含展示模型刺刀)
Mount a bayonet.
(Display model excluded)

Rail
LC034



放妥軌道，兩側固定勾對齊槍身位置
Align the rail mounting hooks in both sides between the receiver.

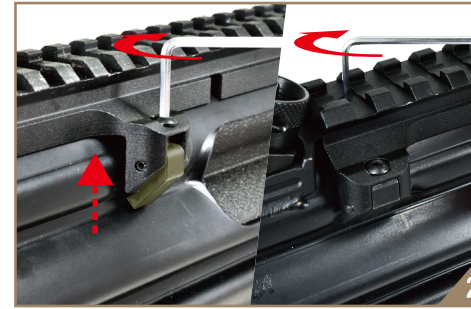

鎖緊螺絲，軌道不可搖晃
Fasten all screws to fix the rail firmly.



安裝範例(不含展示瞄具)
Mount a scope.(Display model excluded)

Handguard
LK003



移除護木固定插銷
Remove the locking-pin in front of the handguard.



適用2/3片式鋰電池，請圖示配置
Compatible with 2 or 3-piece Li-po battery. Installation as shown.



裝回護木時請留意電線位置，插回插銷
Pay attention to the position of wires when replacing the handguard to avoid damage. Insert locking pin again.

EBB ROF. limitation< 700 RPM. To avoid system malfunction.
循環射速需低於700發/分，避免系統故障



EBB系列裝飾槍機可動
EBB=Electric Blow Back, with an action dummy bolt carrier.

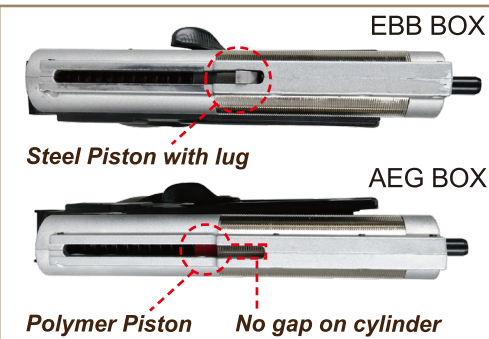

LK33 AEG齒輪箱可更換為EBB形式
LK33 AEG gear box could be changed to an EBB type.



EBB運作時嚴禁碰觸拋殼口，慎防夾傷
Do not touch the ejection port during EBB operation, Be careful not to get caught.



注意! 請使用適當尺寸電池，防止產品損壞
Please choose the compatible batteries to prevent damages.

Other LK Parts

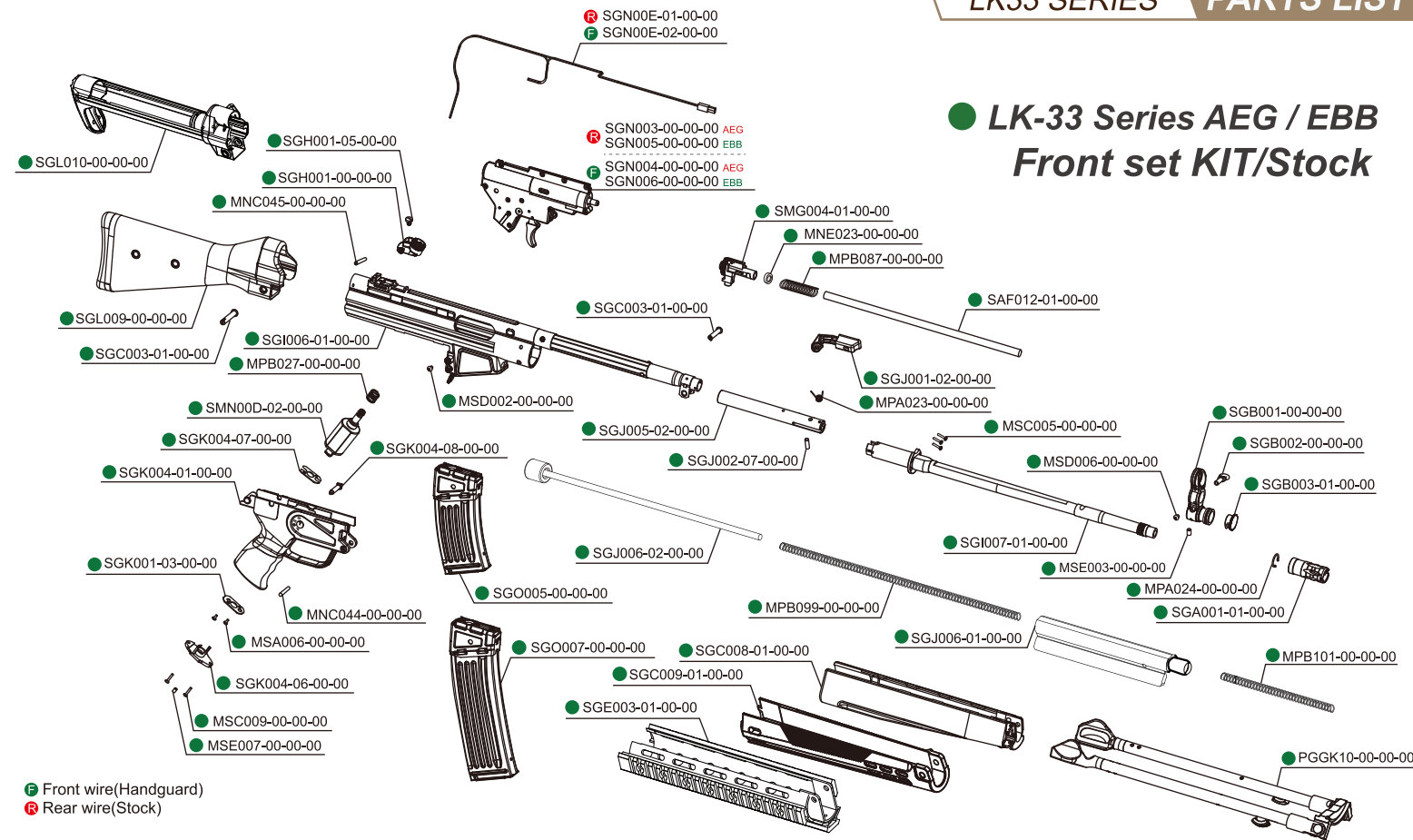

● LK-33 Series AEG / EBB Front set KIT/Stock